

## Cartridge Filter Housings

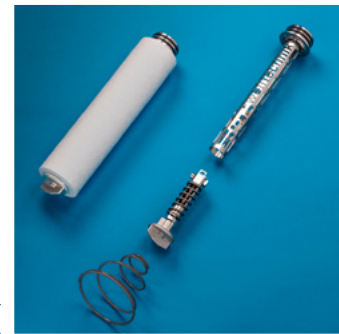

### 01WTGD Cartridge Filter Housing made of stainless steel with round thread and insertable center post

Multi-purpose filter housing for a wide range of industrial applications. The two-piece housing construction consists of a filter head made of casted stainless steel and a sump with round threads to screw it into the filter head. The connection sizes of the filter head are 3/4", 1" and 1 1/4" for sumps to accept one filter element in the lengths of 4 7/8"–5", 9 3/4"–10" or 19 1/2"–20". For the installation of cartridge filter elements with double open end (DOE), an additional plug-in center post with 222 adapter and compression nut is required. Cartridge filter elements with adapter code 0 or code 3 (222/cap) can be installed without a center post. A spring in the bottom of the sump is provided to hold the filter element in position.



#### 01WTGD Cartridge Filter Housing

Top-Seller

#### Technical data

Material:	Filter head: 1.4404 (AISI 316L) Sump: 1.4404 (AISI 316L) / 1.4571 Installations: 1.4404 (AISI 316L) Spring: 1.4310 Gaskets: PTFE O-Ring: Viton (optionally made of Buna, Silikon, EPDM, FEP-encapsulated)
Inlet / Outlet:	3/4", 1" or 1 1/4"
Vent:	1 x 1/8" vent valve 1 x 1/8" with plug
Drain:	3/8" with plug
Filter elements:	Quantity: 1 (DOE* with center post or Code 0 / Code 3 without center post) Length: 4 7/8"–5", 9 3/4"–10", 19 1/2"–20"
Max. operating pressure:	25 bar
Max. operating temperature:	95°C (depending on filter element)
Flow rate:	The flow rate capacity correlates to the nominal diameter of the connections, the length of the sump and the characteristic curve of the flow rate of the chosen filter element.

#### Applications

- Process filter for paint and varnishes
- Pre-filter for water recycling plants
- Particle filter for cleaning baths
- Fine filter for cooling circuits
- Post-filter for active carbon filters or ion exchangers
- Protection filters for valves and spray nozzles
- End-filter for bottling liquids

#### Features and Benefits

- Filter head made of cast stainless steel in 3/4", 1" or 1 1/4"
- Sump for 4 7/8"–5", 9 3/4"–10" or 19 1/2"–20"
- Round threads to screw the sump into the filter head
- For cartridge filter elements code 0 / code 3 (without center post)
- An additional center post is required for cartridge filter elements with both ends open (DOE)
- Inline alignment of in- and outlet.
- Simple to clean as easy to take apart

\* One additional center post is required for each DOE cartridge filter element!

### Spare parts

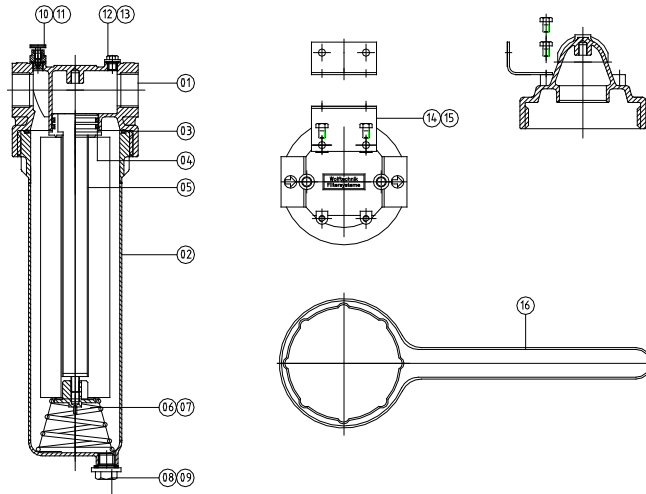

### Spare parts

Pos.	Description	Material	Order designation	Order No.
1	Head	Stainless Steel 1.4404	01WTGD -Kopf-R¾	008293
			01WTGD -Kopf-R1	008292
			01WTGD -Kopf-R1¼	008291
2	Sump	Stainless Steel 1.4404 1.4404/1.4571	01WTGD-Unterteil-05	008294
			01WTGD-Unterteil-10	008295
			01WTGD-Unterteil-20	008296
3	O-ring for housing	Viton	01WTKF-ORVIT-GEH-CB/BB/GD	006085
		Viton FEP-encapsulated	01WTKF-ORFEP-GEH-CB/BB/GD	008323
		EPDM	01WTKF-OREPDM-GEH-CB/BB/GD	004872
		Buna	01WTKF-ORBUN-GEH-CB/BB/GD	003687
		Silikon	01WTKF-ORSIL-GEH-CB/BB/GD	999996
4	Center ring	Viton	70003-B-ORVIT-222	007175
		Viton FEP-encapsulated	70003-FEP-Viton	004405
		EPDM	70003-C-EPDM	006610
		Buna	70003-D-Buna	004061
		Silikon	70003-A-Silikon	007176
5	Center post, complete	Stainless Steel 1.4571 / 1.4404	WTGD-FST-05-222-TG	S009566
			WTGD-FST-10-222-TG	S009567
			WTGD-FST-20-222-TG	S009568
6	Adjustment screw	Stainless Steel 1.4404	01WTKF-FST-Gegenhalter-222-TG	006944
7	Locking pin	Stainless Steel 1.4404	01WTKF-Andrückfeder-222-TG	006222
8	Drain plug	Stainless Steel 1.4571	01WTKF-ASTOP-R3/8-T	000700
9	Drain gasket	PTFE	01WTKF-DIPTFE-Ablass	000692
10	Vent valve	Stainless Steel 1.4571	01WTKF-EVENT-T	000715
11	Vent gasket	PTFE	01WTKF-DIPTFE-Entlüftung	006441
12	Vent plug	Stainless Steel 1.4571	01WTKF-ESTOP-R1/8-T	000720
13	Vent gasket	PTFE	01WTKF-DIPTFE-Entlüftung	006441
14	Mounting bracket	Stainless Steel 1.4571	01WTKF-Winkel-TG	000752
15	Screw	Stainless Steel A4	01WTKF-Winkel-Schraube	006443
16	Key	Plastic	01WTKF -Schlüssel-TG	000369

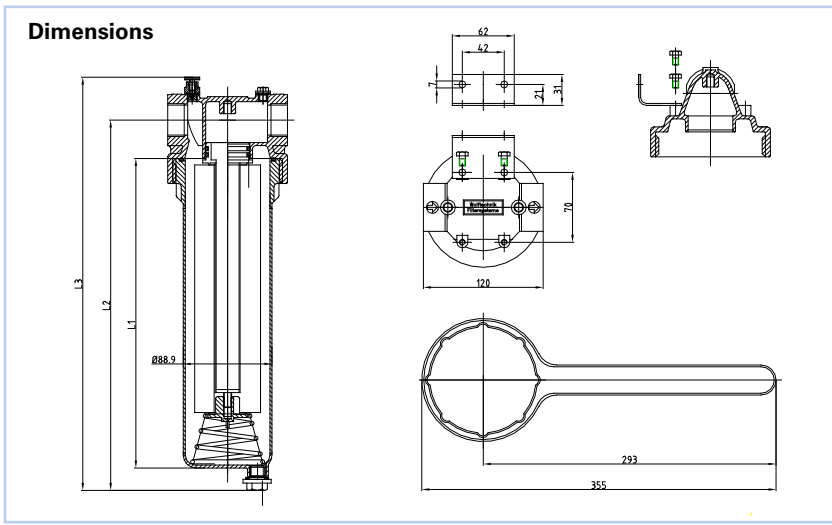

**Dimensions**

Housing	L1	L2	L3	Inlet/Outlet	Filter Cartridge
01WTGD05	185	245	290	3/4", 1", 1 1/4"	4 7/8" - 5" (124 - 127 mm)
01WTGD10	310	370	415	3/4", 1", 1 1/4"	9 3/4" - 10" (248 - 254 mm)
01WTGD20	565	625	671	3/4", 1", 1 1/4"	19 1/2" - 20" (496 - 508 mm)

For cartridge filter elements with adapter code 0 and code 3 (222/cap) – without center post.  
 An additional center post is required for DOE cartridge filter elements (double open end)

## Order example

01WTGD	10	R	1	222	T	V	-
1	2	3	4	5	6	7	8

## Order information

Pos.	Designation
1	01WTGD-Cartridge filter housing
2	05: Size for 4 7/8" - 5" cartridges
	10: Size for 9 3/4" - 10" cartridges
	20: Size for 19 1/2" - 20" cartridges
3	R: BSP Pipe thread
	F: Flange
	M: Screwed pipe connection DIN11851
	TC: TriClamp connection
4	3/4: Connection 3/4"
	1: Connection 1"
	1 1/4: Connection 1 1/4"
	20: DN20
	25: DN25
	32: DN32
5	222: Cartridge filter elements for code 0 and code 3
6	T: Head made of casted stainless steel, Sump made of stainless steel Installations made of stainless steel
7	V: Viton-O-ring
	F: FEP-encapsulated Viton
	S: Silicone-O-ring
	E: EPDM-O-ring
	B: Buna-O-ring
8	Labeling for special equipment

## Accessories, Mountings & Adapters

Fittings and accessories for our filter housings made of stainless steel, brass or plastic increase the use and safety for the user and for the operating personnel. We offer useful accessories and options for all filter housings to complete the standard versions.

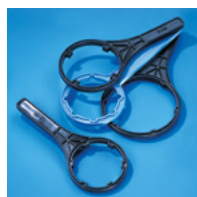

### Accessories

Vents necessary for operation to release the pressure when changing filters, instruments suitable for rest-drainage, pressure controls and gauges when using the filter housings are a typical equipment for pressure vessels, and can be custom made and delivered for specific use.

### Mountings

Operating and assembly aids such as ring spanners, volume reducers for the reduction of the housing volume, wall brackets or tripods are useful accessories for the installation and maintenance of the filter housings.

### Adapters

Adapter components are often necessary when installing Filter elements into the filter housings. We therefore offer a multitude of adaptation possibilities, e.g. adapters for range adjustments, adapters for the connection of additional filter elements or adapters as a centring assistance to be used in the installation of the filter elements.